

# MUNRO GROOVED-END FITTINGS & PIPE CONNECTORS

[TEXCELINDUSTRIAL.COM](http://TEXCELINDUSTRIAL.COM)



# THE BETTER WAY TO MAKE CONNECTIONS

Every Munro product is designed, engineered and manufactured to work better for longer. Made to USA standards to easily interchange with other major manufacturers, Munro grooved-end fittings and pipe connectors are ideal for use in countless applications. With over 50 years of manufacturing expertise, our primary drivers for construction and innovation are safety, effectiveness, and ease-of-use.

## HDPE COUPLING AND HDPE TRANSITION COUPLING



Lighter and easier to handle than other HDPE couplings, these fittings offer a cost-effective option for permanent or temporary HDPE pipe installations. Engineered to satisfy the working pressure of DR 7.3 to DR 32.5, every Munro HDPE coupling uses 4 high-quality bolts and flanged nuts or washers for improved tightening and holding.

Sizes available: 2", 3", 4", 6", 8", 10", 12"

## STANDARD FLEXIBLE COUPLING



Made to USA standards, to easily interchange with other major manufacturers, the Munro flexible coupling is ideal for use in countless piping applications where misalignment might be present. The M7705 can accommodate vibration, thermal stress and moderate seismic activity. This tried and true coupling offers pressure ratings to 500 psi, depending on pipe size and wall thickness.

Sizes available: 2", 3", 4", 6", 8", 10", 12"

## GROOVED-END TEE



Munro ductile iron grooved fittings are made to USA standards for consistent interchangeability with other major manufacturers. Pressure ratings conform to the pressure rating of installed couplings.

Sizes available: 2", 3", 4", 6", 8", 10", 12"

## GROOVED-END 90° AND 45° ELBOW



Made to USA standards for consistent interchangeability with other major manufacturers. Pressure ratings conform to the pressure rating of installed couplings.

Sizes available: 2", 3", 4", 6", 8", 10", 12"

## GROOVED-END CAP



Made to USA standards for consistent interchangeability with other major manufacturers. Pressure ratings conform to the pressure rating of installed couplings.

Sizes available: 2", 3", 4", 6", 8", 10"

## FLANGE ADAPTOR AND UNIVERSAL FLANGE ADAPTOR

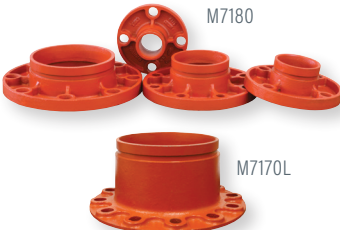

The flange adaptor is the ideal product to transition from flanged to grooved components and is compatible with ANSI Class 125/150. Pressure ratings conform to the pressure rating of installed couplings. The all-in-one universal flange adaptor accepts ANSI 125/150, PN10, PN16, JIS, 10K and BS-10E flange patterns. In addition, a longer grooved-end makes this unique fitting easier to install.

M7180 sizes available: 2", 3", 4", 6"

M7170L sizes available: 8", 10", 12"

## CONCENTRIC REDUCER



Made to USA standards for consistent interchangeability with other major manufacturers. Pressure ratings conform to the pressure rating of installed couplings.

Sizes available: Groove x groove: 10"x8", 12"x10", 6"x2", 6"x4", 8"x4", 8"x6";

Groove x FPT: 2"x1", 2"x1.5", 4"x2", 6"x4"

## MECHANICAL TEE



Mechanical tees, sometimes called saddle tees, allow you to create a mid-pipe branch outlet quickly and easily. A gasket seals on the joined pipe, in the neck of the outlet. The connection is female threaded. These fittings are not recommended for vacuum applications.

Sizes available: 4"x2", 6"x2"

## GROOVED ADAPTER NIPPLES



Munro grooved fittings pressure ratings conform to the pressure rating of installed couplings.

Made of carbon steel, ASTM A733, ANSI B1.20.1

Sizes available: Groove x weld: 4"x6", 8"x6"; Groove x FPT: 2"x4", 3"x4", 4"x6", 6"x6"

## SWAGE NIPPLE



Munro schedule 40 zinc electroplated carbon steel swage nipples conform to

MSS SP-95, with ASME B1.20.1 NPT threads.

Sizes available: 2"x1 1/2", 3"x2", 4"x3", 6"x4"

## MUNSTER TANK FITTING



Built for tank penetration, this unique one-piece design eliminates the need for separate threaded connections. The integrated hexnut makes for easy wrench installation. This fitting saves time and effort!

Sizes available: 2", 4"

## CAM VALVE



A better alternative to butterfly valve to cam lock assemblies, these NBR lined aluminum valves have a stainless steel disc and is up to 90% lighter than traditional assemblies. Eliminates leak points by more than half!

Replacement handles & ears also available.

Sizes available: 4"

## GASKETS, NUTS & BOLTS

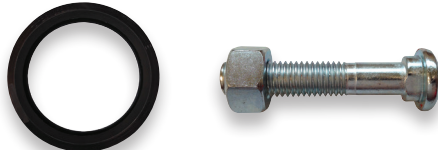

Made to USA standards for consistent interchangeability with other major manufacturers. These wear parts are essential components that require replacement and maintenance.

Sizes available: All replacement parts for M7705, M95 and M97





Ahead Of The Curve.

Ask Us About Our Other Great Products



HYDRAULIC HOSE

FITTINGS

CRIMPERS



INDUSTRIAL HOSE

COUPLINGS

ASSEMBLIES



COMPRESSED SHEET

SHEET RUBBER

SKIRTBOARD

Distributed by:



800.231.7116 ■ sales@texcelrubber.com | Houston ■ Chicago ■ Delaware ■ Denver ■ Birmingham ■ Sacramento