

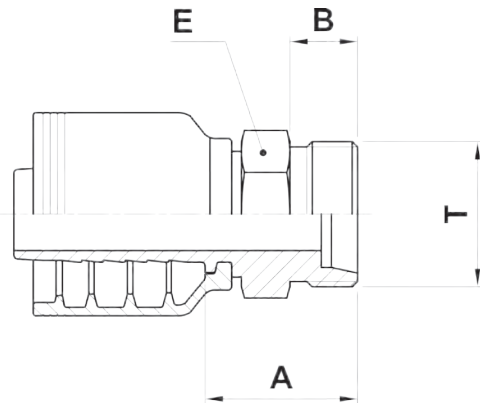

# F4-DHM

Metric DIN Heavy Male



## USE WITH TEXCEL HOSE SERIES

HS3K, HS4K, HS5K (TO SIZE 20), HS5K-XT, HS6K (TO SIZE 16), HBR1 (SIZES 12 TO 32), HBR2 (SIZES 12 TO 32), HB3K-12 & 16, HB4K-12

ONE-PIECE NO-SKIVE FITTING

CODE	HOSE			THREAD SIZE	TUBE SIZE	A		B		E		Box Qty	
	SIZE	INCH	DN			[in]	[mm]	[in]	[mm]	[in]	[in]		[mm]
F4-0824-DHM	08	½	12	M24X1.5	16S	1.15	29.2	0.55	14.0	0.95	1 <sup>5</sup> / <sub>16</sub>	24.0	25
F4-1230-DHM	12	¾	19	M30X2	20S	1.32	33.5	0.63	16.0	1.18	1 <sup>3</sup> / <sub>16</sub>	30.0	15
F4-1236-DHM	12	¾	19	M36X2	25S	1.50	38.0	0.71	18.0	1.42	1 <sup>7</sup> / <sub>16</sub>	36.0	15
F4-1642-DHM	16	1	25	M42X2	30S	1.61	41.0	0.79	20.0	1.81	1 <sup>13</sup> / <sub>16</sub>	46.0	10
F4-2052-DHM	20	1 ¼	31	M52X2	38S	1.96	49.9	0.87	22.0	2.17	2 <sup>3</sup> / <sub>16</sub>	55.0	5