

F6-FLH60

Code 62 Flange 60° Bend

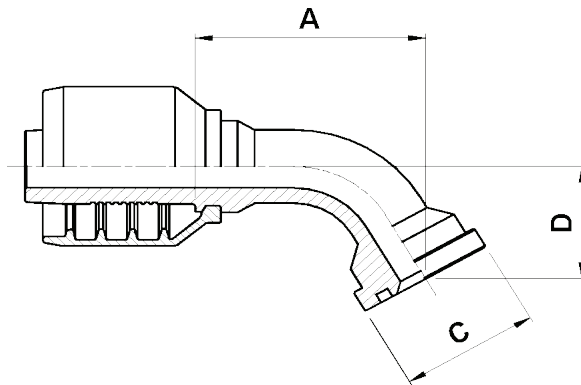

USE WITH TEXCEL HOSE SERIES

HS5K (size 24 to 32), HS6K (size 20 to 32)

ONE-PIECE NO-SKIVE FITTING

CODE	HOSE			FLANGE	A		C		D		Box Qty
	SIZE	INCH	DN		[in]	[mm]	[in]	[mm]	[in]	[mm]	
F6-2020-FLH60	20	1 ¼	31	1 ¼"	4.45	113.0	2.13	54.0	2.75	69.8	5
F6-2424-FLH60	24	1 ½	38	1 ½"	6.04	153.5	2.50	63.5	2.17	55.0	3